

Evacuation Guidelines:

- When the building alarm sounds, we evacuate.
- Please evacuate quickly and quietly. Please help those who are mobility impaired or those with young children. Please meet your family and friends **at the rally point**. Children in Religious Education classes (RE) will be taken to the rally point.
- If there is an issue with your assigned evacuation exit, please proceed to the next nearest exit to evacuate.

Rally point (place to meet and reorganize): in front of **Arlington Town Hall, 730 Massachusetts Avenue**, to west of the First Parish campus

To **exit the First Parish building** there are **6 doors: West Mass Ave, East Mass Ave, Pleasant Street, Parish House, Vestry** (*exits onto grass*), **Annex** (*has steps/not a wheelchair exit*).

To reach the **Arlington Town Hall, 730 Mass Ave rally point**:

- From **West Mass Ave** and **East Mass Ave** doors: proceed north to Massachusetts Ave then turn left (west) along Mass Ave. Follow Mass Ave to the **Arlington Town Hall, 730 Mass Ave** entrance on your left.
- From **Parish House, Annex, Vestry, and Pleasant Street** doors: proceed to the walkway next to the cemetery either
 - turn right (west) towards Robbins Library and Peg Spengler Way. Turn right (north) on Peg Spengler Way and proceed to Massachusetts Ave.
 - or
 - turn left (east) towards Pleasant Street. Follow the walkway to Pleasant Street and turn left. Follow Pleasant Street to Massachusetts Ave. Turn left at Mass Ave.in both cases follow Massachusetts Ave. (west) to **Arlington Town Hall, 730 Mass Ave**.

To **exit the First Parish building** from the:

Parish House (areas numbered PH0xx, PH1xx, PH2xx) -

- If not on the first floor use stairwells to reach the **first floor**.
For those on wheels: the elevator is the only accessible route from any other floors of the Parish House to the first floor.
- Exit through the **Parish House** door or the **West Mass Ave** door.

Annex (areas numbered A1xx) -

- Exit through the **Annex** door.
Note: The Annex door has steps. If steps are a barrier, exit through the West Mass Ave door.

Reception area (areas R1xx) -

- Exit through the **West Mass Ave** door.

Kitchen, Mechanical Room and first floor **Men's and Women's restrooms** -

- Exit through the **West Mass Ave** door, the **Vestry** door, or the **East Mass Ave** door.

Vestry -

- Exit through the Vestry door or the **East Mass Ave** door.

Sanctuary area -

- The choir/organ half of the Sanctuary including the balcony and the narthex (East Mass Ave door entrance area) – Exit through the **East Mass Ave** door.
- The pulpit/bell half of the Sanctuary including the balcony as well as the choir room, the green room and the sexton's closet – Exit through the **Pleasant Street** door.

First Parish Emergency Exits Map

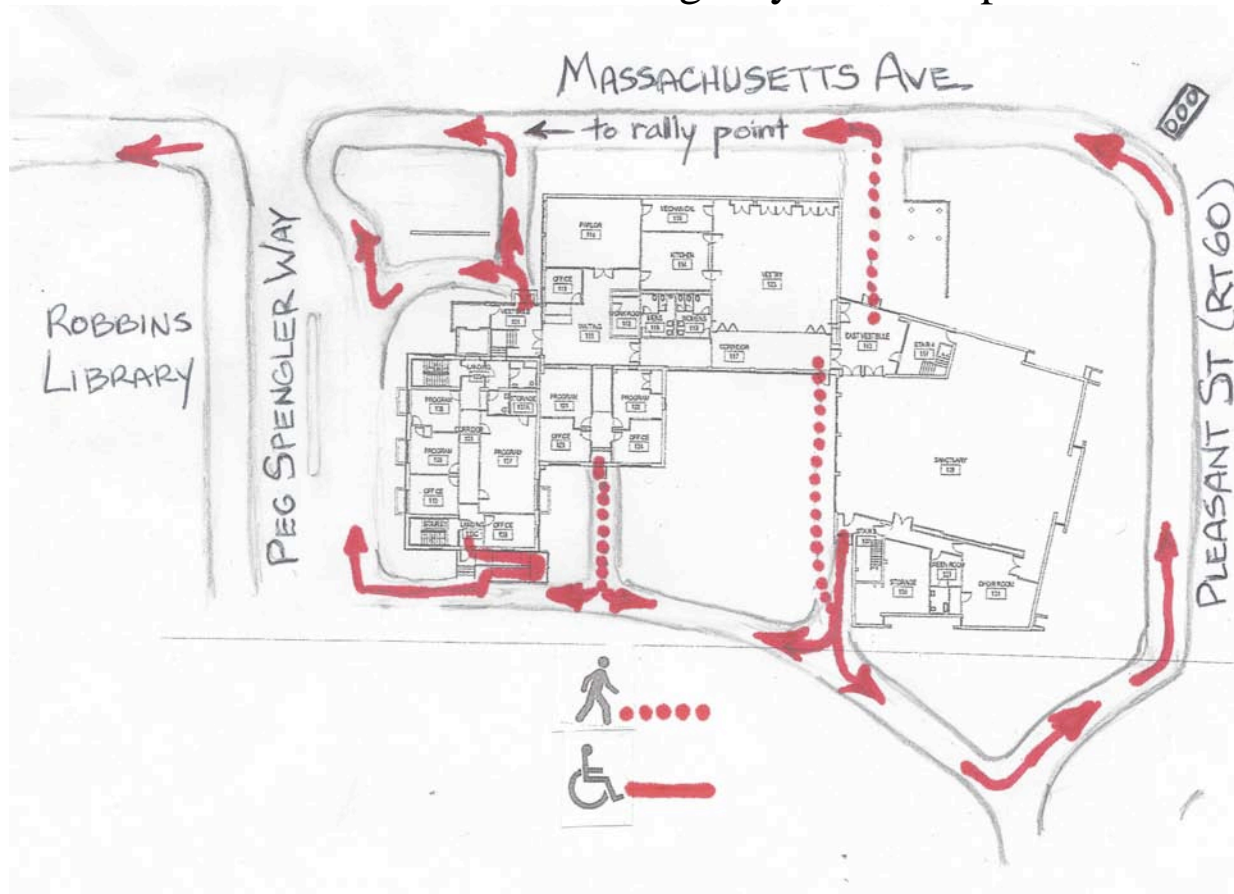

Map to First Parish Rally Point – in front of Town Hall, 730 Mass Ave

